



# The Preservationist

Spring 2010

## Annual Meeting

Thursday, March 4, 2010

### Board of Directors

#### President

Susan Munger

#### Vice President

Kathleen Barrett

#### Secretary

Laurie Deredita

Lloyd Beachy

Doug Braun

Laura Cordes

Art Costa

Christopher Deveau

Krystal Kornegay

Rachel Pattison

Phil Turner

Wick York

#### Executive Director

Sandra Kersten Chalk

#### IT Specialist

Scott Kadey

#### Archivist

Julie Bennett-Jones

#### Address

New London Landmarks

49 Washington Street

P.O. Box 1134

New London, CT 06320

(860) 442-0003

#### Email:

info@

newlondonlandmarks.org

#### Web Site:

newlondonlandmarks.org

#### Office Hours:

Monday 6 Friday

9:00 am 6 1:00 pm

#### The Preservationist Editor

Sandra Kersten Chalk



Printing: Copy Cats



President Susan Munger welcomes members and guests

Over sixty friends and members joined the celebration to ðshred the mortgageö on the Bishop House and honor New London preservation efforts at the Annual Meeting at Union Station. The **Restoration Award** was presented to **Old Town Mill** and the **City of New London** for the splendid and yearsölong effort to restore the oldest industrial site in Connecticut. It is a beautiful site and we urge you to visit when they have their next public event. **Richard Gipstein** earned the **Clifford Stone Award** for many years of work to preserve and care for architectural treasures in New London. The **Custom House Maritime Museum** has taken over stewardship of **New London Lighthouse** and the **Rescue Award** honors their plans to provide limited access to the site. **Marian Shilstone** was thanked for her work on Landmarks projects with the **Volunteer Award**. The **Most Endangered Place** in New London this year is the **Lighthouse Inn**! Perhaps next year the Inn will earn the Rescue Award and will be back in business.

**Wick York**, a Board Member who played a major role in the restoration, talked about the history of Landmarks efforts to save the Bishop House, "it was about to fall down when we took it over" and the meeting closed with ðShredding the Mortgage!ö

Over sixty friends and members joined the celebration to ðshred the mortgageö on the Bishop House and honor New London preservation efforts at the Annual Meeting at Union Station.

The **Restoration Award** was presented to **Old Town Mill** and the **City of New London** for the splendid and yearsölong effort to restore the oldest industrial site in Connecticut. It is a beautiful site and we urge you to visit when they have their next public event. **Richard Gipstein**



Lloyd Beachy, Susan Munger, Sandra Chalk & Wick York ðshred the mortgage!ö

## The David Bishop House

In 1988, when New London was really down-in-the-dumps, the Board of New London Landmarks made a significant investment in a derelict house on Washington Street: the David Bishop House. This was followed by several very difficult years as NLL struggled to restore the house.



Today, the two apartments and ground-floor office for Landmarks are a major asset for the organization. In March we paid off the mortgage and the Board of Directors thanks all of our members and contributors who have made this possible.



## January, 2010

New London Landmarks began the new decade with two very special events. The Sacred Spaces Forum on January 12, held in the sanctuary of the 2nd Congregational Church, was planned to encourage efforts to preserve New London's eight historic churches in the downtown National Register District. The Transit New London ...All Aboard! event on January 29, was organized to provide information about the city's historic role as a transportation center and to discuss short and long term solutions to transit challenges in the 21st century.

**SACRED PLACES: Elizabeth Terry, Educational Director of Partners for Sacred Places** in Philadelphia, brought a message of hope and collaboration to an enthusiastic audience of over sixty people attending from Hartford, Windsor and other cities in the region. Ideas developed through her years of experience with small, historic congregations throughout the country provided specific examples of successful programs. In a stimulating, interactive presentation she challenged the audience to learn about each other as the first step toward learning to look critically at their community. She introduced the Sacred Places Public Value Tool as one method churches can use to find new ways to play significant roles in their communities and to calculate the value of their theological, social, and economic connections to their neighborhoods.



**David Bahlman, Director of the State of Connecticut Historic Preservation Office, CT Commission on Culture and Tourism**, discussed the history of historic preservation and offered a realistic picture of the limited funding available. However, some funding and consultation services are available and he encouraged congregations not to be discouraged, but to rise to the challenge, to find new solutions to care for their historic buildings and to maintain their missions within the community.

The care and maintenance of their stained glass windows is topic of concern to all the historic churches and **Ronald Bovard, President of Bovard Studio** in Iowa, provided an illustrated presentation on the art and techniques of restoring and repairing stained glass. He also warned about problems caused by improper venting and cleaning of the windows. After the forum he visited several of the churches to discuss their specific problems.

**TRANSIT NEW LONDON . . . ALL ABOARD!** An exciting introduction from **Mary Ellen Jukoski, President of Mitchell College**, set the tone for the day. As a rail enthusiast, she experiences directly the needs of students and their parents for accessible public transportation between campus and home.

**Dr. John Renne**, Urban Planning and Transportation Studies Department, University of New Orleans, introduced ideas of the many ways an active transit center leads to Transit Oriented Development (TOD). In communities across the country transit centers can create a venue for investment by private sector partners leading to increased retail, commercial and residential development. Enthusiastic about what he sees in New London, he encouraged the audience that this is the time to move forward with a vision and strategic planning, so when the economy recovers the city is ready for development.

**Larry English** who led the Regional Intermodal Transportation Study, provided details on the study recommendations which included expanded facilities for bus passengers and, at the request of ConnDOT, a pedestrian bridge over the railroad tracks which could be extended to the parking garage and Cross Sound Ferry docks. As Jim Butler, Director of Southeastern Connecticut Council of Governments (SCCOG) noted, the study has provided a long list of recommendations, immediate, short and long-term. When and how these recommendations are implemented requires extensive planning and funding.

## Directors Report

Sandra Kersten Chalk

Funding for non-profit agencies is always a challenge and in the current economic climate it is especially difficult. Loyal members and contributors to the Annual Fund are essential to our operation and we sincerely thank all who have donated to the fund this year.

We have an interesting idea for a spring/summer fund raising event that will promote new development and business in New London, encouraging interest in the many amenities of urban living. I hope you will join in the fun to discover New London today.



Connecticut Commission  
on Culture & Tourism

I also want to thank the following organizations for grants and support we received to present the two Forums and our other activities this past year.

Frank Loomis Palmer Fund,  
Bank of America, Trustee

City Center District

Sierra Club, CT Chapter

McCue Mortgage

NATIONAL  
TRUST  
FOR  
HISTORIC  
PRESERVATION

Charles Evens Hughes  
Memorial Foundation  
Preservation Fund



## Prospero's America: John Winthrop, Jr., Alchemy, and the Creation of New England Culture, 1601-1676

Walter Woodward, the Connecticut State Historian, has just published an important new work on the founder of New London, John Winthrop, Jr.

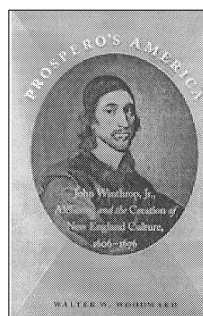

Placing Winthrop fully within the Atlantic world, this book will enlighten all readers interested in local history.

Save this date: Sunday, April 11, 2010. Join the New London County Historical Society and Walter Woodward at a special reception on the Connecticut College Campus.

Details of time and place to come.

## Parade Parade

June 4 & 5, 2010

### Parade Parade

The City of New London is planning a celebration on the weekend of June 4 and 5 to open the new Parade Plaza.

**Friday, June 4:** New London's pre-Revolutionary public space will be celebrated as an attractive open space for a culturally diverse 21<sup>st</sup> century city. Commissioned performances will welcome visitors and a convergence of performing ensembles in a grand music and dance event.

Stay tuned as planning goes forward.



### Saturday, June 5: History On Parade

Festivities will open with a re-dedication of:  
**Nathan Hale Schoolhouse (1773 to Present)** on Nathan Hale Plaza

The plaque recognizing the first  
**Episcopal Church in New London (1732)**  
**Soldiers and Sailors Monument (1896)**

Landmarks and the N L County Historical Society are collaborating on **History On Parade** to provide an interactive activity around the new historic bronze plaques in the Parade. These handsome plaques give brief stories on aspects of New London history and suggest a visit to local museums to learn more.





### Annual Appeal Donations

**\$500 And Above**

Frederick & Kathleen Barrett  
Lloyd & Sandy Beachy  
John & Sarah Steffian

**\$250 and Above**

Anthony & Elizabeth Enders  
David Hayes  
Wick & Rodie York

**\$100 and Above**

John & Laurie Deredita  
Lawrence DeVars  
Richard & Heather Grigsby  
Morgan & Lisa McGinley  
Susan Munger  
George Sprecase  
Philip Turner  
Abby Van Slyck & Mitch Favreau  
Russell & Frances Vocalina  
Michael Wright & Scott Ross

**\$50 and Above**

Harold Arkava  
Nathan & Patricia Belcher  
Martin & Randy Berliner  
Marion Bodde  
David Condon  
Sharon Churchill  
Edgar Forest  
Kathleen Goss  
Edward Hammond  
Peter Kreckovic  
Rose Longo  
James McGuire  
Frank & Linda McLaughlin  
Dr. & Mrs. Daniel Moalli  
Fred Paxton & Sylvia Malizia  
Dennis O'Brien  
Elvira Penrose  
Hubert Ryan  
Pat & Tod Schaefer  
Marian Shilstone  
Adam Sprecase  
Kathleen Wick

**\$25 and Above**

Evan Andriopoulos  
Seymour Benson  
Carol Booth  
Bill Cornish  
Deborah Donovan  
Antoinette DuPont  
Carol Corbeil  
Kevin Doyle  
Jerome & Chris Fischer  
Todd Gipstein  
Armand Lambert  
Edward Murphy  
J. Solomon, Inc.  
Elizabeth Whitley  
Penny Parsekian  
Robert Richter  
Kate Treadwell-Hill  
Barbara Zabel & Thomas Couser

**2010 Members (As of 3-10-10)**
**Individual**

Michel Belt  
Marvin Berger  
Vincentia Belbruno  
Mr. & Mrs. Nathan Belcher  
Marion Bodde  
Judith Cammarata  
Antoinette Dupont  
Sharon P. Churchill  
Barbara Dixon  
Edgar Forest  
Ned Hammond  
Bruce Hyde  
Carmelina Como Kanzler  
Peter Kreckovic  
Michele Kripps

Ellen Lakowsky  
Carolyn Leuze  
Rose Longo  
Ted Nelson  
Anne Pierson  
Hubert Ryan  
Marie Spencer  
Kathy Walburn  
Martha Tita Williams

**Family**

Wadonna & Jack Ashcraft  
John & Laurie Deredita  
Linda & Tom English  
Timothy & Paul Foley  
Carl & Winifred Josephson  
Frank & Linda McLaughlin

**Renew Your Membership Today!**

Peter & Christina Moore  
Edward Murphy  
Margaret Palmer & Robert Hauschild  
Elvia M. Penrose  
Helen Sandalls & Roger Beers  
John & Joan Wiles

**Contributor**

George Jagger

**Patron**

Barun Basu  
Mary Beth Baker  
Laura Cordes & Chris Nelson  
Anthony & Elizabeth Enders  
Rick & Heather Grigsby

**Membership year in New London Landmarks is from April 1st through March 31st.**

Benefits of membership include receiving copies of The Preservationist, postcards and mailings about special events and, most importantly, support for our work to preserve and protect New London's historic urban landscape, homes and buildings.

**Individual: \$25   Family: \$35   Contributor: \$50—\$75   Patron: \$100 and above   Corporate: \$200 and above**

## Historic Plaque Application

**DAVID BISHOP  
HOUSE**



**c1796**

If your New London home/building is at least 50 years old, it may qualify to receive an historic marker listing its date and original owner. The information gathered in this process aids in neighborhood preservation efforts.

Our volunteer title researchers study land, tax and water records, historic maps, and city directories to establish your building's first owner and date of its construction.

The researchers also welcome any oral history or copies of old documents relating to your building that you may have. Please allow at least 16 - 20 weeks for completion of the research and delivery of the durable, hand-lettered, sealed hardwood plaque.

PLAQUE ADDRESS \_\_\_\_\_

NAME \_\_\_\_\_ ADDRESS \_\_\_\_\_

DAY PHONE \_\_\_\_\_ E-MAIL ADDRESS \_\_\_\_\_

LEGAL OWNER (IF DIFFERENT) \_\_\_\_\_

APPROXIMATE DATE PURCHASED BY CURRENT OWNER \_\_\_\_\_ APPROXIMATE AGE OF PROPERTY \_\_\_\_\_

ADDITIONAL INFORMATION:

MEMBERSHIP STATUS: YES ☐ NO ☐

PRICE OF PLAQUE: \$250.00 Non-member \$235.00 Members

A non-refundable deposit of \$100.00 is required with this application. Balance is due upon completion.

### Historic Plaque Completed

**64 Mountain Avenue**

**Marian A. Crocker**

**1874**

**January, 2010**

**continued from page 2**

### The Panel Discussion

After a brief break for lunch, a local panel, moderated by Molly McKay from the Sierra Club, was convened to comment on the plans and ideas presented during the Forum. The Panel also received questions from the eighty participants in the morning session.

Paul Altman, Southeast Area Transit; Rich Caruso, Caruso Music; Joseph Celli, Pro-Park; Sandra Chalk, New London Landmarks; Tom Clark, Bike New London; Todd O'Donnell, Union Station; Anthony Silvestri, New London Harbour Towers; Adam Wronowski, Cross Sound Ferry Services and City Manager Martin Berliner took part in the discussion.

They all expressed enthusiasm for the prospect of having a regular schedule of Shore Line East trains providing local service between New London and New Haven. Each representative provided insights to their own views of economic development, and there was general agreement that Transit Oriented Development, as described during the Forum, could play an important role in the revitalization of downtown business and the overall economy of New London that is currently taking place.

Continued on page 6

## January 2010 - Transit New London . . . All Aboard!

continued from page 5

The illustration at the right is one of the visions for short-term improvements to the transit area. It shows extensive development of facilities for SEAT and Greyhound passengers with a new, glass-fronted bus station and the up-and-over bridge across the tracks for rail passengers to get to the Boston tracks when a train is in the station.

**Skip Smallridge**, Urban Designer with Crosby / Schlessinger / Smallridge, LLC looked further into the future describing how New London lost its original closely packed urban streetscape with the extensive demolition during Urban Renewal.



New London waterfront area in 1910

New London waterfront area in 2010

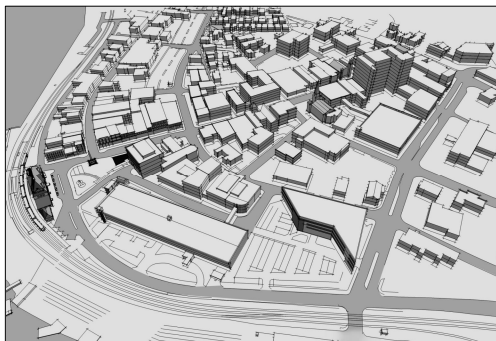

Skip suggested serious consideration of very long-term planning as development begins surrounding the transit center. There are under-utilized parcels of land north of State Street which could become available for new development in the next 15 to 20 years.

New London currently has a good deal of open space—much of it used for large parking lots, which tend to discourage active pedestrian sidewalks and street activity. We need parking in New London, and a busy transit center requires extensive parking, but it is equally important for an urban center to have attractive sidewalks, the shops, restaurants and galleries that attract pedestrians. New London has several unique advantages to encourage walkers and bicyclists: the Thames River, interesting architecture, museums and historic sites within easy walking distance of each other. While today the city has empty retail and commercial space, twenty-first century development favors urban centers near good transportation facilities.

New London will change, new economic activity will bring ideas for development in the downtown area as well as Fort Trumbull, the transit center, and this area around Governor Winthrop Boulevard. Good planning now is necessary to have a vision of what the city could be and how New London should develop in the next twenty years.

NOTE: Copies of the transit study are available on the SE CT Council of Government web site: [www.seccog.org](http://www.seccog.org)

In the illustration, at left below, the empty spaces are areas where current structures, the parking garage and large parking lots could become available for new construction. In the center illustration the parking garage area becomes a mixed-use area with a garage in the center of the large space and a variety of commercial and residential development surrounding it on Water Street and an extension of Bank Street. The illustration on the right shows the same development from the south.

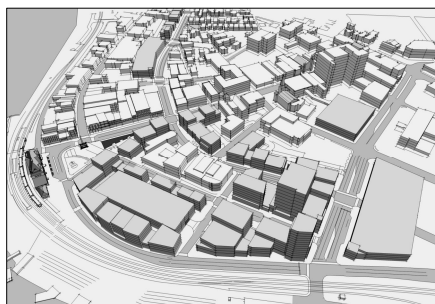
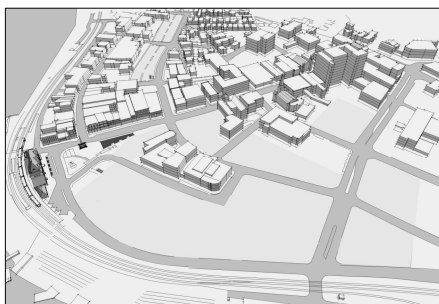



## Items of Interest - Great gift ideas for sale in the Landmarks office

We have set up a small shop in the Bishop House with a variety of items; books, magnets of the ornaments, and miscellaneous bits and pieces you may be interested in. They include the re-printed *Architectural Ornaments Poster* designed by architect Rick Gipstein of Lindsay Liebig Roche. \$10.00

Architectural Ornaments have embellished fine architecture since man first began to construct important buildings. The poster provides great photographs of small architectural details on some of New London's historic buildings. Landmarks encouraged the production of this poster in the hopes it would inspire people to take a longer look at downtown buildings and enjoy the Downtown Waterfront District. We have great architectural treasures here—take a closer look!

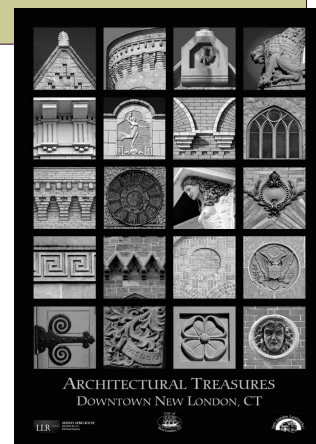

*Pride of Place, State Street, New London*, an illustrated booklet following the development of State Street. It introduces the architects and city benefactors who had a grand vision for the city as a commercial center, building the fine buildings we enjoy today. The current restoration process, begun with the Garde Arts Center, has moved down the street to include nearly every historic building.

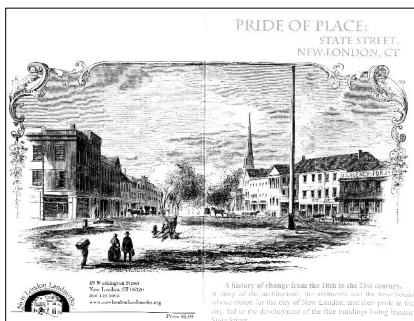

From the Courthouse at the top of this hill to the Parade, New London's historic gathering place, State Street has always been the primary street leading to the busy harbor and Thames River.

Written by Landmarks archivist Heather Tichenor the booklet was supported by a grant from the Frank Loomis Palmer Fund, Bank of America Trustee. \$5.00

## A Question from Japan

Sandra Kersten Chalk

I never know what will happen next around here and recently I received a request from Hideo Isso in Japan asking about J.N. Harris and requesting a photo of the Harris House. Evidently Mr. Jonathan Harris donated \$100,000 to build the Harris Science Hall at Doshisha University in Kyoto, Japan. Hideo also asked for more biographical information and that led to some research.

Jonathan Harris was born in Salem, CT on Nov. 18, 1815 and raised on a farm. At 17 he was placed as a clerk in a small country store in Hamburg, CT, and in 1836, he was engaged as clerk with Smith & Cady of New London. In 1838, he opened his own business, starting out with only \$100, as a small grocer.

In *Picturesque New London*, (1910) it stated that he served as Mayor of New London from 1856 to 1862, as Representative in the State Legislature in 1855, and as Senator in 1864. He helped found the Mount Hermon School and the Northfield Seminary. In 1893 he was President of the school. In 1889 he founded and endowed the Harris School of Science at Kyoto, Japan, "With a munificent gift of one hundred thousand dollars."

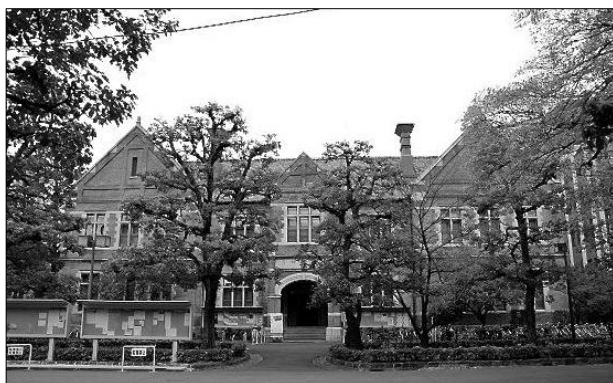

Harris Science Hall, Doshisha University, Kyoto, Japan,



Residence of J. N. Harris, New London, CT 1897



49 Washington Street  
Post Office Box 1134  
New London, CT 06320

U.S. POSTAGE  
PAID  
New London, CT  
06320  
Permit No. 64  
Non-Profit Org.

### NEW LONDON LANDMARKS

#### CALENDAR OF EVENTS

*Save the Date: Saturday, June 26, 2010.*

We're in the beginning planning stages of our spring/summer fundraiser—a tour to encourage everyone to see and experience the joys of urban living in New London. We will highlight new apartments/condos, new businesses in historic downtown buildings and other new amenities in the city that are creating a vibrant residential community.

How long has it been since you strolled the streets in downtown, visited shops and art galleries, enjoyed a cocktail overlooking the river or treated your favorite friends to dinner in one of New London's restaurants?

Visit new small businesses—new apartments and condos—and see how the Parade Plaza has transformed the historic parade.

Save the date!.



#### Sunday, April 11:

New London County Historical Society  
Reception and book signing  
Walter Woodward's new book:

**Prospero's America: John Winthrop, Jr.,  
Alchemy, and the Creation of New England  
Culture, 1601-1676**

Connecticut College Campus.

Details of time and place to come.

#### Friday & Saturday, June 4, 5:

##### **Parade Parade**

A celebration to open the new Parade Plaza

**Friday evening:** A musical extravaganza

**Saturday afternoon: History On Parade** and

Re-dedications of Nathan Hale Schoolhouse

First Episcopal Church plaque

Soldiers & Sailors Monument

Details to come.

#### Saturday, June 26:

##### **Live Urban In New London**

The tour will highlight a variety of studios, unique businesses, apartments and condos in downtown New London that are creating the place to live for a great urban experience.

Details to come.